

Minera Horizontal

This is an economically efficient facade, in terms of both the product and the fixing method. The method results in a small proportion of overlapping area. The facade is extremely easy to fit and can be installed by fitters and building contractors without expertise in the installation of natural stone facades.

TECHNICAL INFORMATION

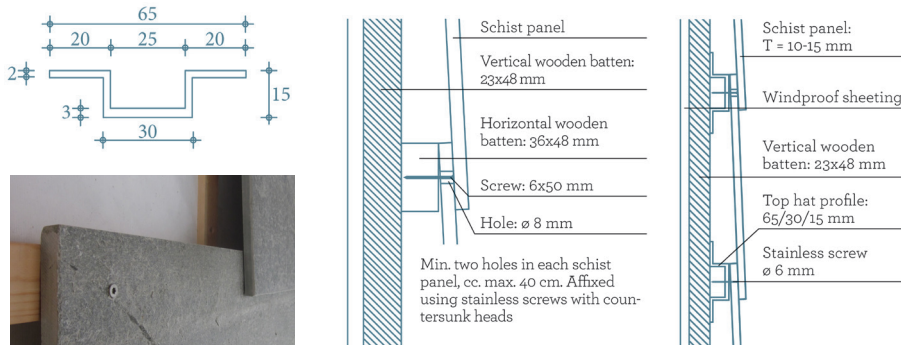

Supplied with core drilled holes for fixing. 8 mm holes are located 30 mm from top edge. Centre distance between holes is max. 40 cm. The product is supplied with overlap already calculated for – simply order the actual area to be covered.

Most common dimensions

Widths 20, 30 and 40 cm, by random lengths or in fixed lengths.
Thicknesses: Oppdal 10-15 mm, Otta and Offerdal 12 mm.

Erection

Exterior insulation and air barrier: 23 mm vertical battens, horizontal battens 36x48 mm or aluminium profiles.

Fixing

The schist panels are affixed on horizontal wooden battens of ore pine or impregnated timber. Alternatively, the schist panels may be affixed to aluminium profiles. In order to prevent water from penetrating the vertical joints, metal trim or roofing felt may be added to the joints, width 10 cm.

In order to accommodate expansion as a result of fluctuations in temperature and achieve effective water run-off, the panels may be fitted with a distance of 2-3 mm between them.

The schist panels are fitted with a 50 mm overlap and affixed to the battens/profiles using 6 mm stainless screws with countersunk heads in acid proof quality.

REFERENCE PROJECT

Kystverket Midt-Norge

Location:
Ålesund, Norway

Quantity:
1 300 m²

Architect:
Slyngstad Aamlid
Arkitekter

Awards:
The council architecture prize 2003.

Builder:
Statsbygg

The Schistad prize 2004.

Year of construction:
2000



OTTA



Otta Pillarguri
Natural



A smaller share
Otta Rust Natural

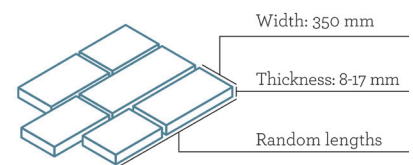

TYPES OF SCHIST, SURFACES, EDGES AND FORMATS



Edges:

Delivered with sawn, broken or milled edges.

Format:

Width 10-60 cm x length 10-200 cm. May be assembled in patterns with varying heights.

